

## BT JUMP PLUS DUAL KNEE BRACE



Designed for cases of cruciate ligament, luxation of the patella, knee joint conditions such as arthritis and arthrosis, varus and valgus. It can be used both as an alternative to surgery, and in post-surgery. The brace has two pockets, which contain two angled splints that restrict the movement of the knee when necessary. The brace can also be used without splints for conditions such as arthritis and arthrosis. This is because the compression it provides increases the blood pressure in the area, thus raising the temperature and reducing the pain caused by the conditions.

### ADVANTAGES

Ensuring the stability of the affected part often means aiding recovery. Two angled lateral splints in aluminium inserted into special pockets restrict movement, as required, controlling the area that needs to be held still, while the abdominal belt keeps the support in place, making sure it does not slip down or rotate.

### FEATURES

- ▶ The brace can be used in pre- and post-surgery.
- ▶ Breathable fabric.
- ▶ Excellent wearability.
- ▶ Hand washable.
- ▶ Shortenable bandages.



### RECOMMENDATIONS FOR USE

- ▶ During the period of restraint, it is advisable not to leave the dog alone for too long, because it might try to remove the brace by biting or scratching it.

### SIZES

Tg.	Circ. A	Circ. B	h A-B
XXS*	13-8 cm	5-3 cm	8 cm
XS	18-16 cm	7-5 cm	10 cm
S	25-21 cm	15-8 cm	15 cm
M	31-26 cm	16-10 cm	18 cm
L	34-29 cm	18-12 cm	22 cm
XL	over 36 cm	-	25 cm

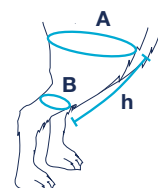

balto  
TUTORI ORTOPEDICI PER ANIMALI

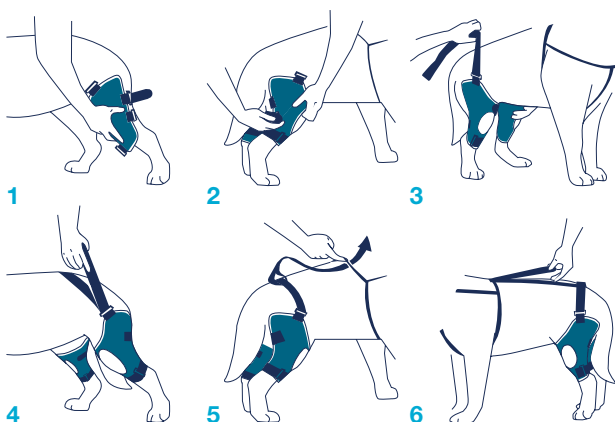

\* XXS size is recommended for Chihuahua and dogs weighing 2-4 kg.