



BT LUX SHOULDER BRACE



The BT Lux brace is designed to limit overall abduction of the shoulders of your 4-legged friend. It can be used for minor issues (like inflammation) and for shoulder diseases that require limiting abduction and movement of the joint. It can also be used as a post-operative device to promote gradual rehabilitation of the joint.

It is helpful for:

- instability of the shoulder joint;
- dysplasia;
- joint laxity or hypermobility;
- dislocation;
- inflammation.

Support is provided by stiff material inside the brace at shoulder height to increase compression and limit movement of the joints.

ADVANTAGES

BT Lux works with your dog to gradually regain motor function. The comfortable padding combines practicality, convenience and optimal stabilization.

FEATURES

- ▶ The brace simultaneously compresses both shoulders.
- ▶ Breathable fabric.
- ▶ Adjusts for a better fit.
- ▶ Can be hand-washed.



RECOMMENDATIONS FOR USE

- ▶ During the period of restraint, it is recommended that the dog not be left alone very long because it could try to remove the brace by biting or scratching it.
- ▶ The length of all of the straps and closures can be adjusted for a better, tighter fit to the dog (see figure 3).

SIZES

Available in three adjustable sizes.

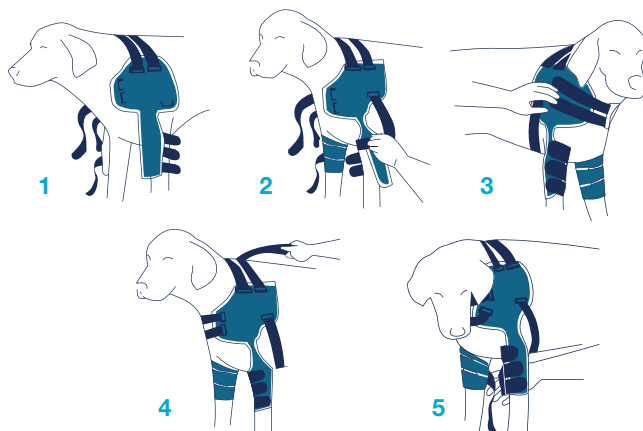

There are two straps between the elbow joint braces that can be used to bind the two joints together. **Note:** this solution is only required when used post-operatively or in case of serious disease that requires greater limitation of movement of the anterior joints. If there is no need to bind the two elbow braces, the safety straps can simply be neatly closed upon themselves.